

CEILING MOUNTED CASSETTE

Wide Air Flow

Improved vanes reduce the curved area and provide better air and temperature distribution.

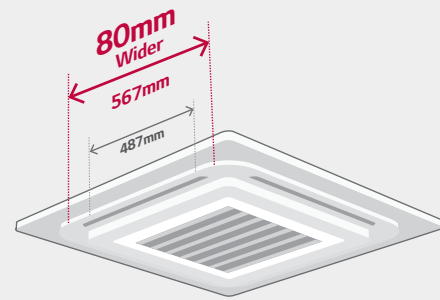

Conventional

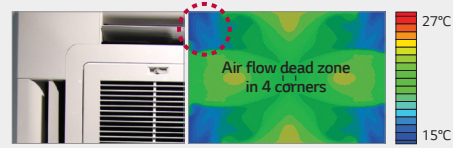

LG Cassette



Convenient Panel Installation

The detachable corner design makes it easy to adjust the hanger during installation and to check for leakages in the drain connection pipe.

Detachable Corner Design

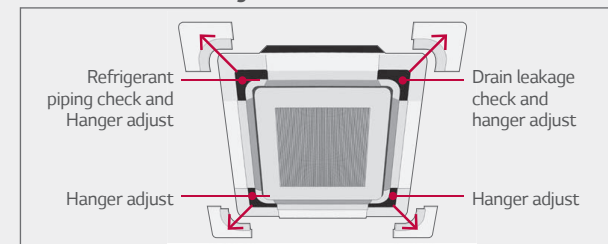

Drain Leakage Check

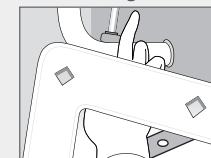

Hanger Adjust

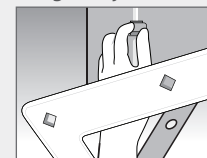

It is easy to install the panel to the body, using the button type panel design.

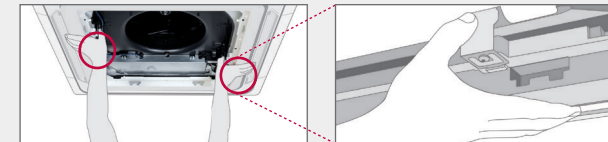

Independent Vane Control

The Independent Vane Operation feature uses separate motors, making it possible to control all four vanes independently.

All Vane Operation

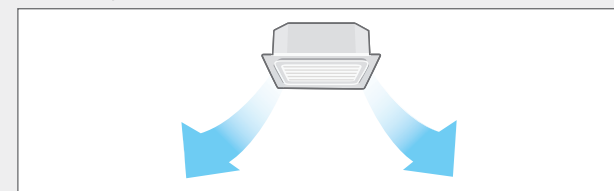

Independent Vane Control

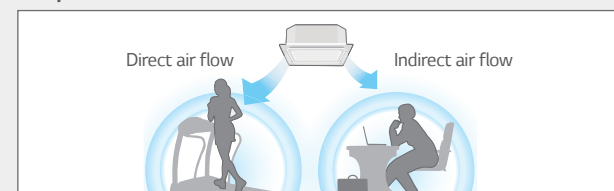

* Wired remote controller PQRCVLSLO (QW) applied

Auto Elevation Grille

Easy filter cleaning with elevation grill.

4-Point Support Structure

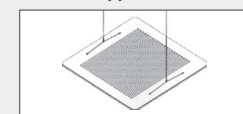

Auto Leveling

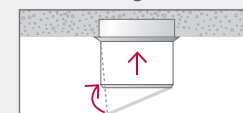

Memory for User's Level

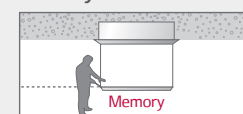

* Operating with wired remote controller PQRCVLSLO(QW) and wireless remote controller included in PTEGMO.

* Except CT09 NR2 / CT12 NR2 / CT18 NQ4 * Applied to cassette panel PT-UMC1



Auto Stop Detection



Various Indoor Units

Capacity (kW)	1.5	2.1	2.6	3.5	5.3	7.0
1 Way Cassette	-	-	MT09AH NU1	MT11AH NU1	-	-
4 Way Cassette	MT06AH NRO	MT08AH NRO	CT09 NR2	CT12 NR2	CT18 NQ4	CT24 NP4

Specification

INDOOR				MT09AH NU1	MT11AH NU1	MT06AH NRO	MT08AH NRO
Capacity	Cooling / Heating	Nom	kW	2.6 / 2.9	3.5 / 3.9	1.5 / 1.6	2.1 / 2.3
Power Input		Nom	W	20	20	20	20
Running Current		Nom	A	0.2	0.2	0.4	0.4
Power Supply			Ø / V / Hz	1 / 220-240 / 50	1 / 220-240 / 50	1 / 220-240 / 50	1 / 220-240 / 50
Air Flow Rate		High / Medium / Low	m³ / min	7.5 / 7.3 / 6.8	8.1 / 7.4 / 7.0	7.5 / 6.0 / 5.0	7.5 / 6.0 / 5.0
Sound Pressure	Cooling	High / Medium / Low	dBA	36 / 34 / 32	37 / 36 / 33	31 / 27 / 24	31 / 27 / 24
Sound Power	Cooling	Max	dBA	54	57	48	48
Dehumidification Rate			l / h	1.1	1.2	0.8	1
Dimensions	Body	W x H x D	mm	860 x 132 x 450	860 x 132 x 450	570 x 214 x 570	570 x 214 x 570
Net Weight	Body		kg	13.5	13.5	14.0	14.0
Piping Connection	Liquid		mm (inch)	Ø6.35 (1/4)	Ø6.35 (1/4)	Ø6.35 (1/4)	Ø6.35 (1/4)
	Gas		mm (inch)	Ø9.52 (3/8)	Ø9.52 (3/8)	Ø9.52 (3/8)	Ø9.52 (3/8)
Decoration Panel	Model			PT-UUC1	PT-UUC1	PT-UQC	PT-UQC
	Color			Morning Fog (RAL120-4)	Morning Fog (RAL120-4)	Morning Fog (RAL120-4)	Morning Fog (RAL120-4)
	Dimensions	W x H x D	mm	1,100 x 34 x 500	1,100 x 34 x 500	700 x 22 x 700	700 x 22 x 700
	Weight		kg	4.4	4.4	3.0	3.0

* CT09, CT12, CT18, CT24 are compatible between SCAC and MULTI.

INDOOR				CT09 NR2	CT12 NR2	NEW CT18 NQ4	NEW CT24 NP4
Capacity	Cooling / Heating	Nom	kW	2.6 / 2.9	3.5 / 3.9	5.3 / 5.8	6.7 / 7.5
Power Input		Nom	W	20	20	20	20
Running Current		Nom	A	0.4	0.4	0.4	0.6
Power Supply			Ø / V / Hz	1 / 220-240 / 50	1 / 220-240 / 50	1 / 220-240 / 50	1 / 220-240 / 50
Air Flow Rate		High / Medium / Low	m³ / min	8.5 / 7.0 / 6.0	9.5 / 8.0 / 7.0	13.0 / 12.0 / 11.0	17.0 / 15.0 / 13.0
Sound Pressure	Cooling	High / Medium / Low	dBA	36 / 33 / 30	38 / 35 / 32	41 / 39 / 36	38 / 36 / 34
Sound Power	Cooling	Max	dBA	48	51	55	57
Dehumidification Rate			l / h	1.4	1.7	2.1	2.4
Dimensions	Body	W x H x D	mm	570 x 214 x 570	570 x 214 x 570	570 x 256 x 570	840 x 204 x 840
Net Weight	Body		kg	14.0	14.0	15.5	20.5
Piping Connection	Liquid		mm (inch)	Ø6.35 (1/4)	Ø6.35 (1/4)	Ø6.35 (1/4)	Ø6.35 (1/4)
	Gas		mm (inch)	Ø9.52 (3/8)	Ø9.52 (3/8)	Ø12.7 (1/2)	Ø12.7 (1/2)
Decoration Panel	Model			PT-UQC	PT-UQC	PT-UQC	PT-UMC1
	Color			Morning Fog (RAL 9001)	Morning Fog (RAL 9001)	Morning Fog (RAL 9001)	Morning Fog (RAL 9001)
	Dimensions	W x H x D	mm	700 x 22 x 700	700 x 22 x 700	700 x 22 x 700	950 x 25 x 950
	Weight		kg	3.0	3.0	3.0	5.0

Note: 1. Capacities are based on the following conditions:

Cooling: - Indoor Temperature 27°C (80.6°F) DB / 19°C (66.2°F) WB - Outdoor Temperature 35°C (95°F) DB / 24°C (75.2°F) WB

Heating: - Indoor Temperature 20°C (68°F) DB / 15°C (59°F) WB - Outdoor Temperature 7°C (44.6°F) DB / 6°C (42.8°F) WB

Piping Length - Interconnecting Piping Length 7.5m - Level Difference of Zero

2. Definition of Power Input Nominal conditions - Performance tested under EN14511

3. Due to our policy of innovation some specifications may be changed without notification 4. This product contains fluorinated greenhouse gases (R410A)